

Operation manual

Model: AA17053

Step 1.

Open the Fiber optic terminal box. Check and prepare installation tools and accessories. To establish easy and safe installation put the box where it will be installed and measure the required length of the cable. Prepare the safe installation of the box.



Step 2

Prepare the cable according to the design of the opened box. Strip the cable the required length, minimum 0.5 meter or more, to establish easy and safe installation with enough buffer size. Pass the stripped cable into the upper side of the splice tray.

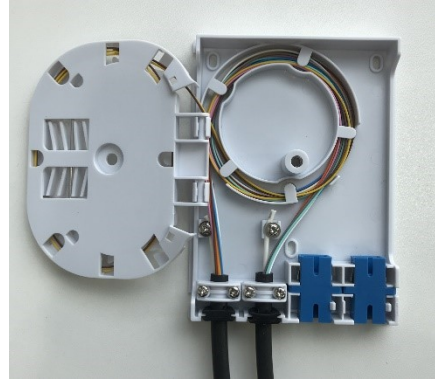

Step 3.

Fix the cable strength member (3) on part (2) and stabilize with cable fixing part (1) inside the box.

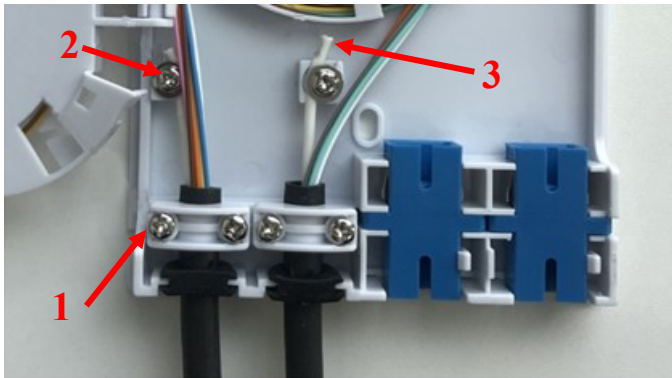

Step 4.

Coil the stripped cable in the splice tray (3). Splice the stripped cable with the pigtails (2). Place the splice sleeves in the tray (1).

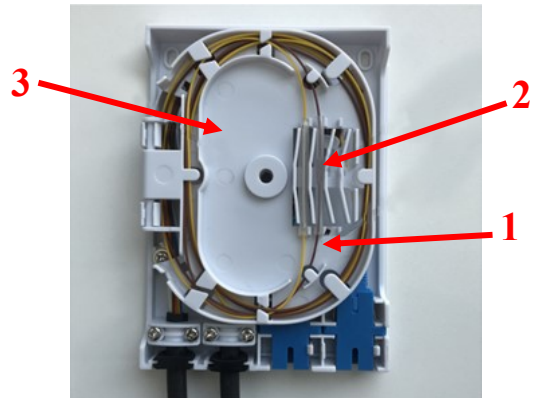

Step 5

Connect the spliced pigtails on the connectors. If you do not connect it with another cable then put the dust protectors in the connectors!

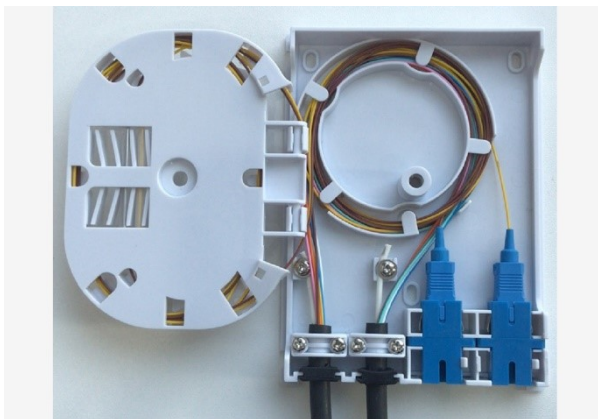

Step 6

Close the box after finish basic light test or the measuring of all fibers.

